

MOLEX MINIFIT 24 PIN P.N.874272402  
MATES WITH MLX5557

MOLEX MINIFIT 12 PIN P.N.874271202  
MATES WITH MLX5557

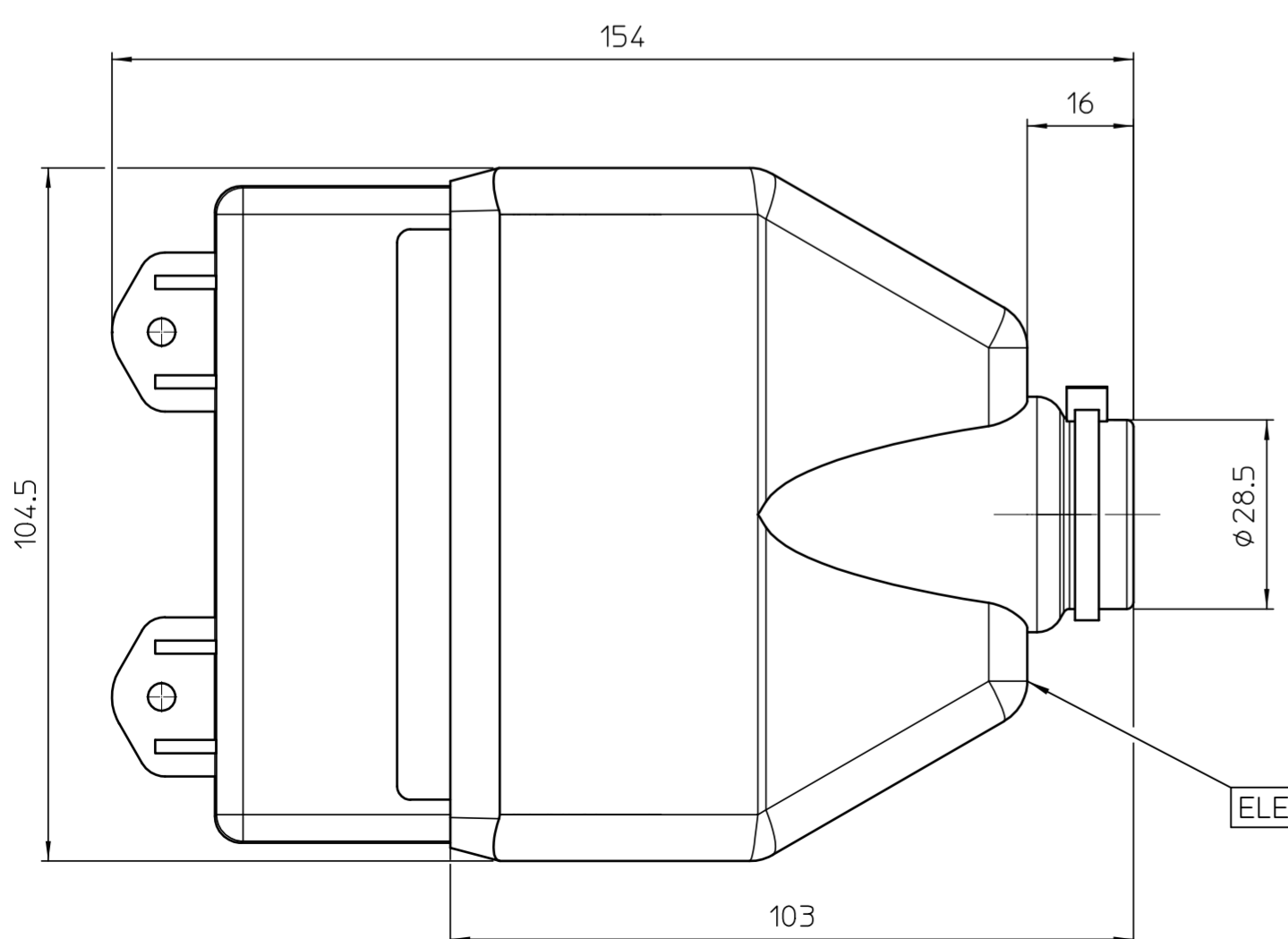
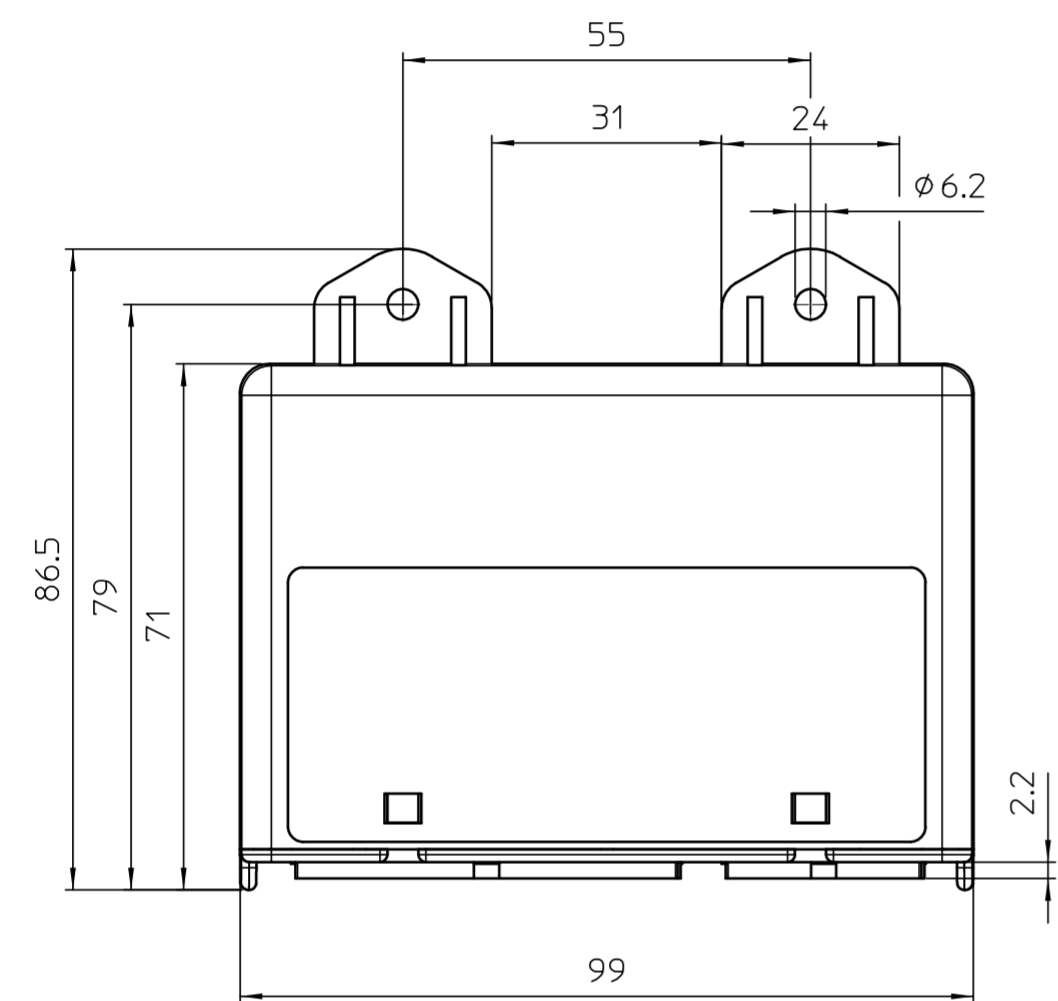
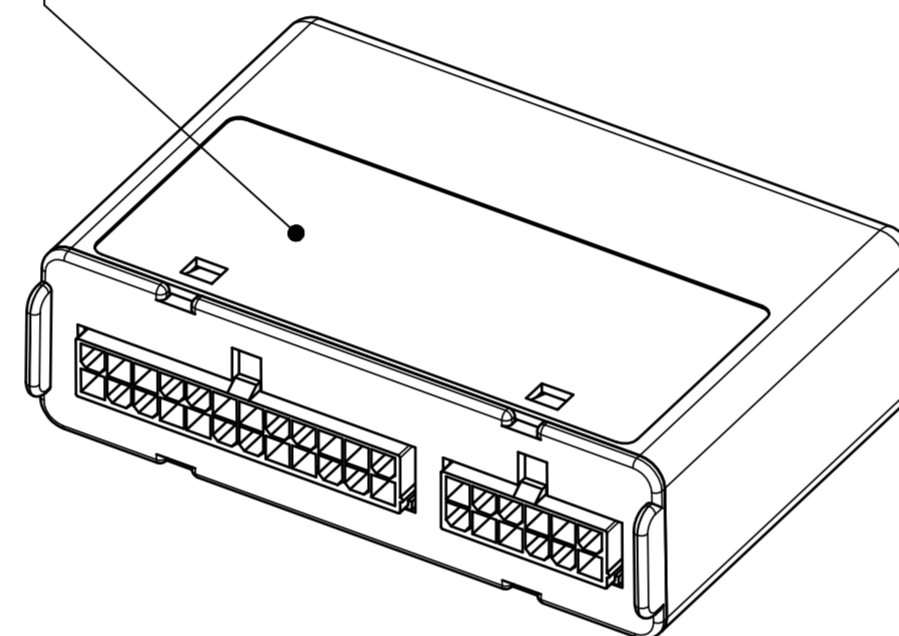
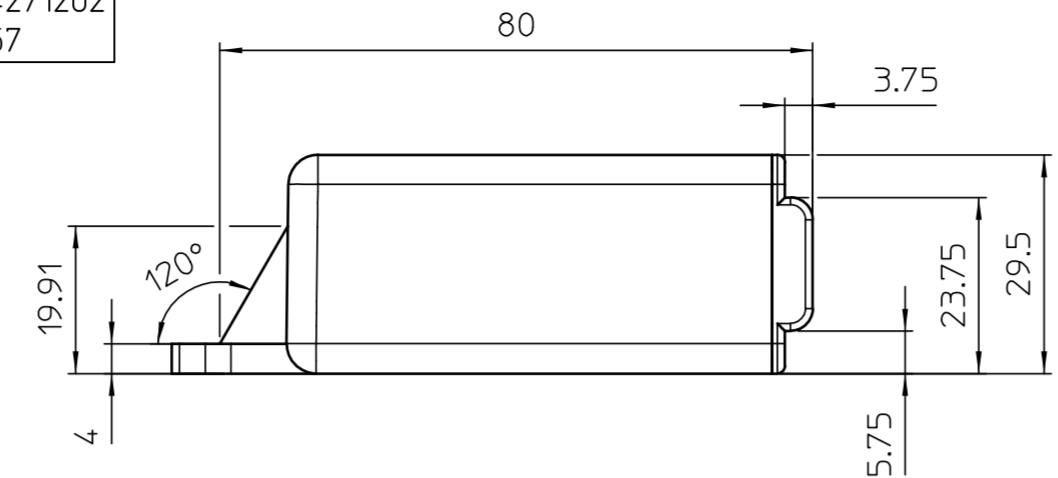
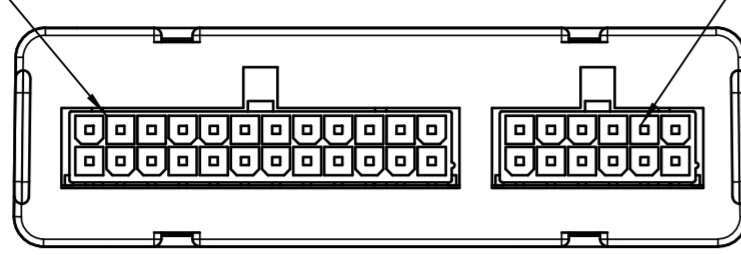

ELECTRONIC CONTROL UNIT WITH SEAL CAP

**GENERAL SPECIFICATION**  
 WEIGHT: 112 gr.  
 OPERATING TEMPERATURE RANGE  
 FULL OPERATING CONDITION -40°C to +85°C  
 PARTIAL OPERATING CONDITION -40°C to +105°C  
 NOT OPERATING CONDITION -40°C to +115°C  
 STORAGE TEMPERATURE -40°C to +130°C  
 OPERATING POWER SUPPLY RANGE  
 FULL OPERATING CONDITION 8V to 16v  
 PARTIAL OPERATING CONDITION 6V to 24V  
 two series batteries: 24V for 1 minute T=-30°C:+25°C  
 alternator damage: 18V for 2 hours T=-30°C:+85°C  
 cranking battery low: 6V to 10V T=-30°C:+85°C  
 NOT OPERATING CONDITION Reserve battery & Load Dump 40V

INDICATORE DI MODIFICA  
 CARATTERISTICA FUNZIONALE  
 CARATTERISTICA SPECIALE

DISEGNO ESEGUITO CON CAD  
 NON SONO AMMESSE VARIAZIONI O MODIFICHE MANUALI

DESCRIPTION	PIN
Lambda emulation output	12
Gnd Ser.Com.	11
+Vbat Ser.Com	10
Throttle position sensor input	9
Tank level input	8
RPM signal input	7
Fuel indicator +5V	6
Fuel indicator gnd	5
Analog Gnd	4
Power Ground	3
Stepper motor PhaseA out.	2
Stepper motor PhaseC out.	1

-	6
-	5
Gasoline injector n°4 In	4
Gasoline injector n°3 In	3
Gasoline injector n°2 In	2
Gasoline injector n°1 In	1

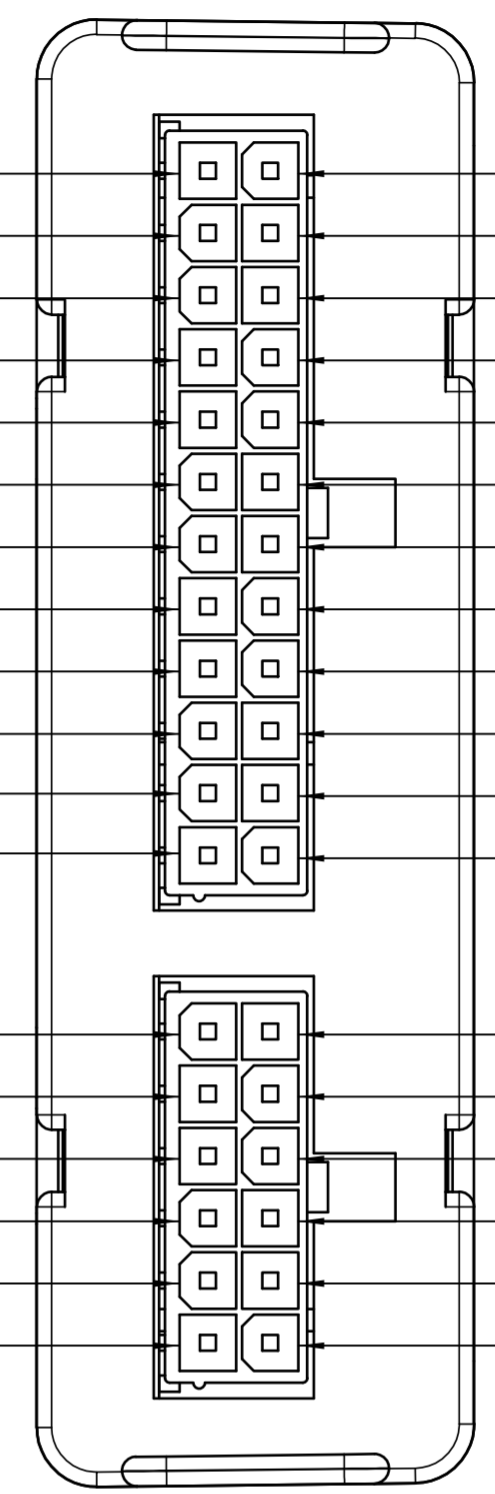

PIN	DESCRIPTION
24	O2 input
23	Ser.Com.Rx
22	Ser.Com.Tx
21	Pressure reducer temperature input
20	12V sensor supply
19	EV's command out
18	Fuel switch input
17	Serial out. To fuel indicator
16	Vbat (+30)
15	Key on (+15)
14	Stepper motor PhaseB out.
13	Stepper motor PhaseD out.

12	-
11	-
10	Gasoline injector n°4 Out
9	Gasoline injector n°3 Out
8	Gasoline injector n°2 Out
7	Gasoline injector n°1 Out

N°MOD.	IND.	MODIFICA	DATA	FIRMA	CONTR.
-	-	-	-	-	-
-	-	-	-	-	-
-	-	-	-	-	-
PARTICOLARE		E.C.U. LC01 4 CYL			616.402.000
TIPO	DESCRIZIONE				MATRICOLA
MATERIALE	N° PEZZI	PESO (g)	MODIFICA	-	
STATO	GRUPPO	TOLLERANZA QUOTE LIBERE			
RIVEST. PROTETTIVO	SCALA	FORMATO	FOGLIO		
TRATT. SUPERFICIALE	DISEGNATO	1 / 1			
TRATT. TERMICO	F.Aloe	-			
EMESSO IL		-			
28 02 06		-			

